

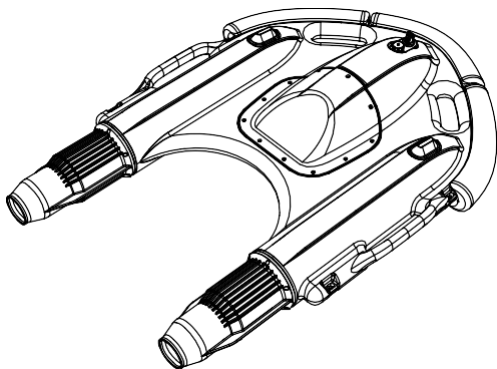

DOLPHIN 1

Quick Start Guide V1.0

 Please read the guide carefully before operating.



OceanAlpha Group Ltd.
www.oceanalpha.com

Specification

Size	1150mm x 835mm x 212mm
Weight	< 15kg
Buoyancy	32kg
Max Transmission Distance	≥500 m
Propelling system	Water-Jet Proplusion
Max Speed	3m/s
Endurance	30min
Charging Time	3h

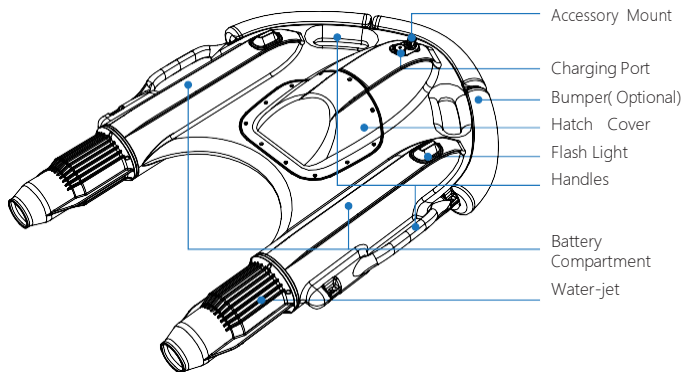
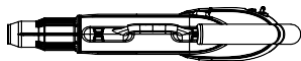
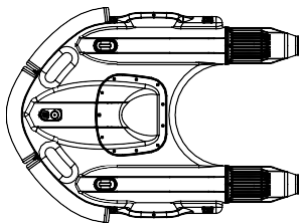

 Note: Please keep the side with Bash lights facing upward.

Set-up Guide

Step 1 : Install Battery to Controller

⚠ Note: Push cover towards the direction to open. Install 6 AA batteries.

Battery compartment is at the bottom

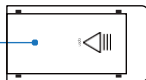

Step 2 : Power on Controller and Lifebuoy

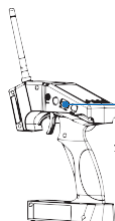

Switch for both controller and lifebuoy. Lifebuoy will automatically power on and connect.

to power on
Switch to OFF to power off

Step 3: Check Connectivity between Controller and Lifebuoy

⚠ Note: The controller display will show lifebuoy status as well as automatically turn the vehicle - as seen by flashing amber lights and beeping sound, indicating a successful connection. The lifebuoy should be charged when the controller display reads less than 22V. The controller's batteries should be replaced after the voltage goes below 7.5V.

Signal Strength

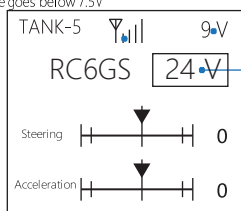

Controller Voltage

Dolphin1 Voltage

Step 4: Dry Test on Ground

⚠ To ensure longevity, do not run more than a minute on the ground

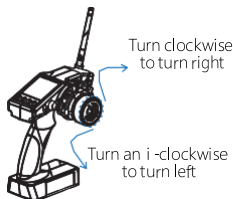

Steering control

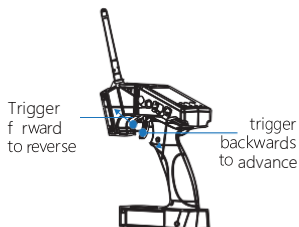

Acceleration control

Step 5: Launching the Lifebuoy

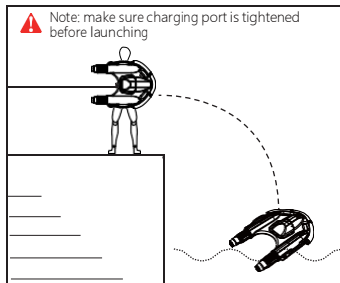

Step 6: Flipping the Lifebuoy

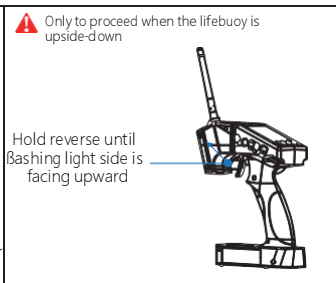

Step 7: Recovering

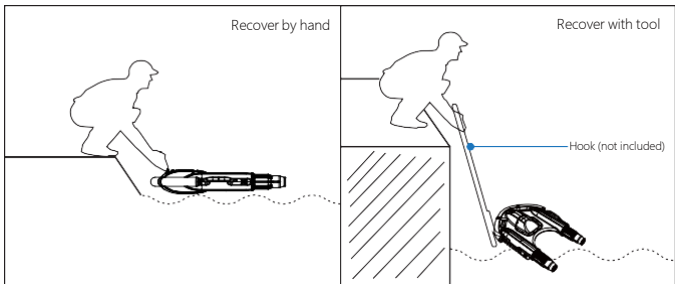

Step 8: Charging

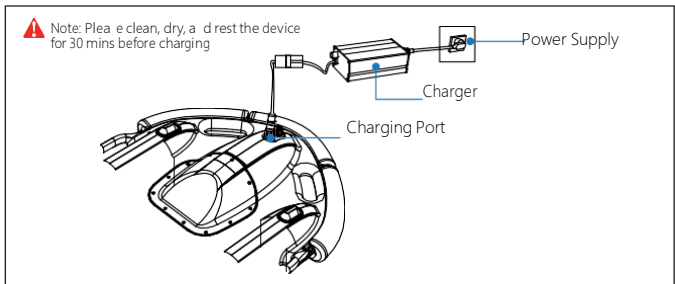

Propeller replacement

- ① Remove the six screws on the nozzle with the allen wrench, and remove the nozzle

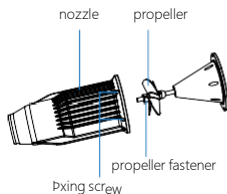

- ② Remove the Pxing screws on the both sides of the propeller fastener

Pxing screw of the propeller fastener

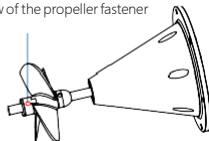

- ③ Remove the fastener and propeller from the shaft in the order indicated below.

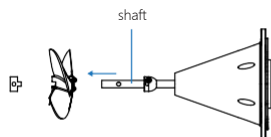

- ⚠ Note:** The propeller slot should be perpendicular to the shaft and aligned with the screw hole

- ④ Replace with new propeller (slot outward)

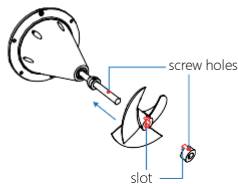

- Attach the fasteners (the slot is inward) and tighten the Pxing screws on both sides. Before screwing on, apply screw glue on one-third of the length of the screw.

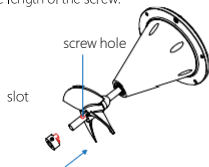

- ⑥ Install the nozzle (the outlet grille is downward). Before screwing on, apply screw glue on one-third of the length of the screw. Tighten the Pxing screw, and the propeller replacement is complete.

screw glue (LOCTITE243)

Hexagon socket screw

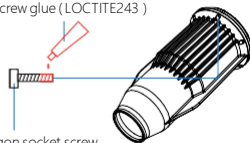

Precautions

1. Operation

- ① The lifebuoy and remote controller must be stored in a ventilated and dry environment. The lifebuoy should be placed on a dedicated rack and in a ready-to-use state.
- ② Remote controller should avoid getting wet and being exposed to the rain.
- ③ The hatch cover should only be removed by authorized technician, otherwise the warranty would be voided.
- ④ Do not use charger other than one provided by the manufacturer.
- ⑤ Battery charging ambient temperature: 0 °C -45 °C (32 °F - 113°F), battery discharge ambient temperature: -10 °C -60 °C (14°F - 140°F).
- ⑥ Storage temperature: 0°C-50°C (32°F - 122°F).
- ⑦ Maximum payload: 150 kg.
- ⑧ Keep distance from magnetic equipment.
- ⑨ Stop using immediately if strange smell and high temperature detected.
- ⑩ When using on a beach, carefully avoid propellers from being clogged by sand or other foreign matter.
- ⑪ Rinse the hull and propellers with fresh water after use to prevent clogging and ensure charging port is dry.
- ⑫ Do not damage the hull with sharp objects.
- ⑬ Do not touch propellers.

2. Battery

- ① Settle 30mins after each use before recharge, make sure power is off. Do not expose to direct sun and rain during recharge.
- ② Do not completely discharge battery before recharge. Stop use immediately when the low battery alarm is on. Charge to stop the alarm.
- ③ Recharge monthly when the lifebuoy is not used for a long period.

Disclaimer

This product is not for recreational purpose and not suitable to minor under 18 years old. Be very cautious when operating around children.

OceanAlpha Group Ltd. does not assume any responsibility for accidents, injuries or equipment damage caused by failure to follow the instructions or warning signs.

Warranty

1. Warranty duration: One year warranty from the date of purchase.
2. Warranty scope: purchased from legitimate agencies, usage under safety factor without misuse or damage by human causes.

3 Warranty Card

Name :
Model :
Purchased Date :
Purchased Location :
Agency Stamp :
User Name :
User Address :
User Phone No. :
Zip Code :

4.Warranty Record :

Date	Reason of Return	Location	Result



www.oceanalpha.com

Manufacturer : OceanAlpha Group Ltd.
Address : RM 702,7/F SPA Centre, NO.53-55 Lockhart Road, Wan Chai, Hong Kong
Website : www.oceanalpha.com
Phone : +86 756 2592836
Fax : +86 756 2592818



Distributor : Garant Safety Ltd.
Address : Ganību Dambis 30B, LV-1005 Riga, Latvia
Website : www.garantsafety.lv
E-mail: order@garantsafety.lv
Mob. Phone : +371 29338808
Phone : +371 67650722

